

XEBEX
FITNESS

Air Ski Trainer ECO ASKI-1-00-E

Floor Stand

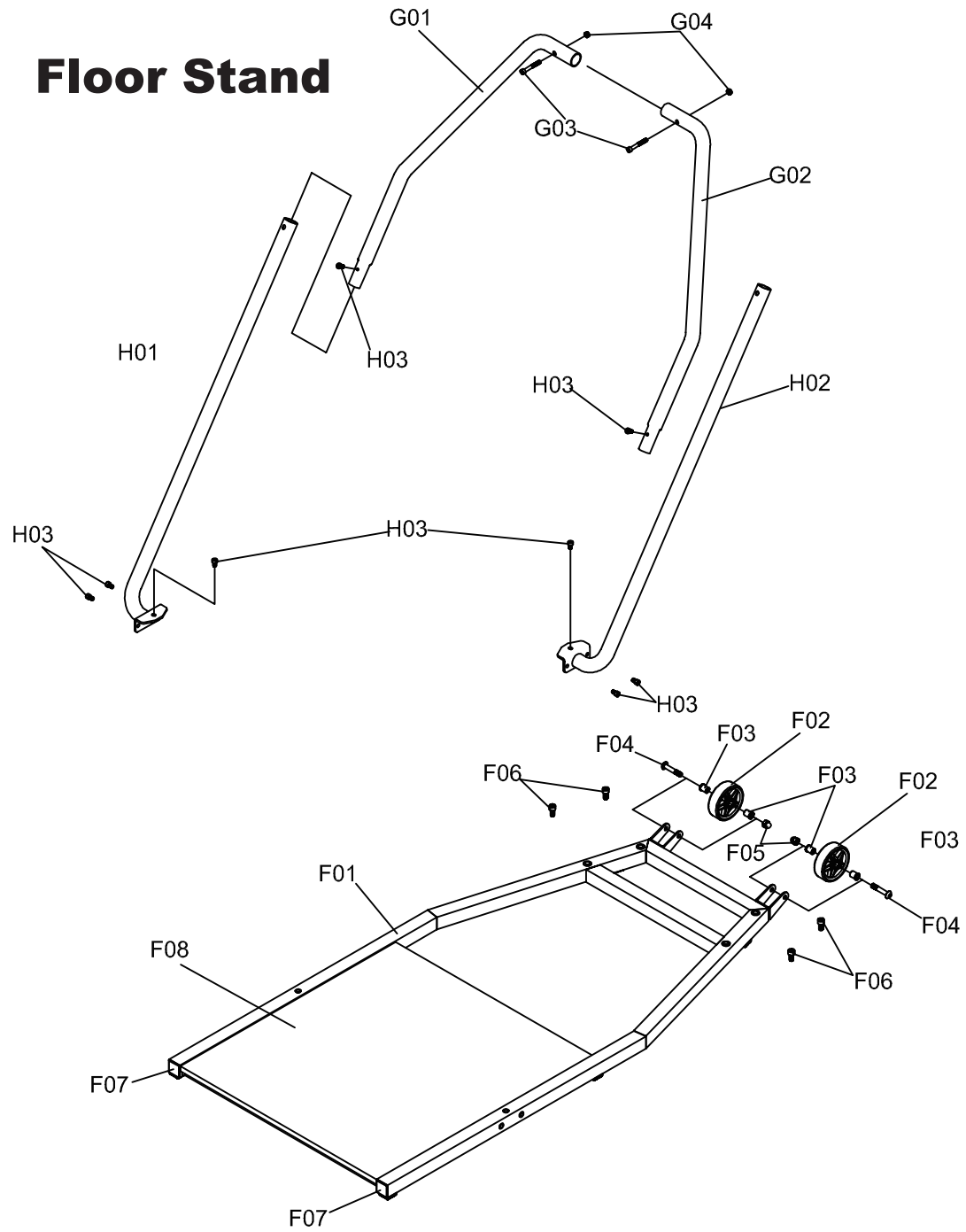

Wall-mount

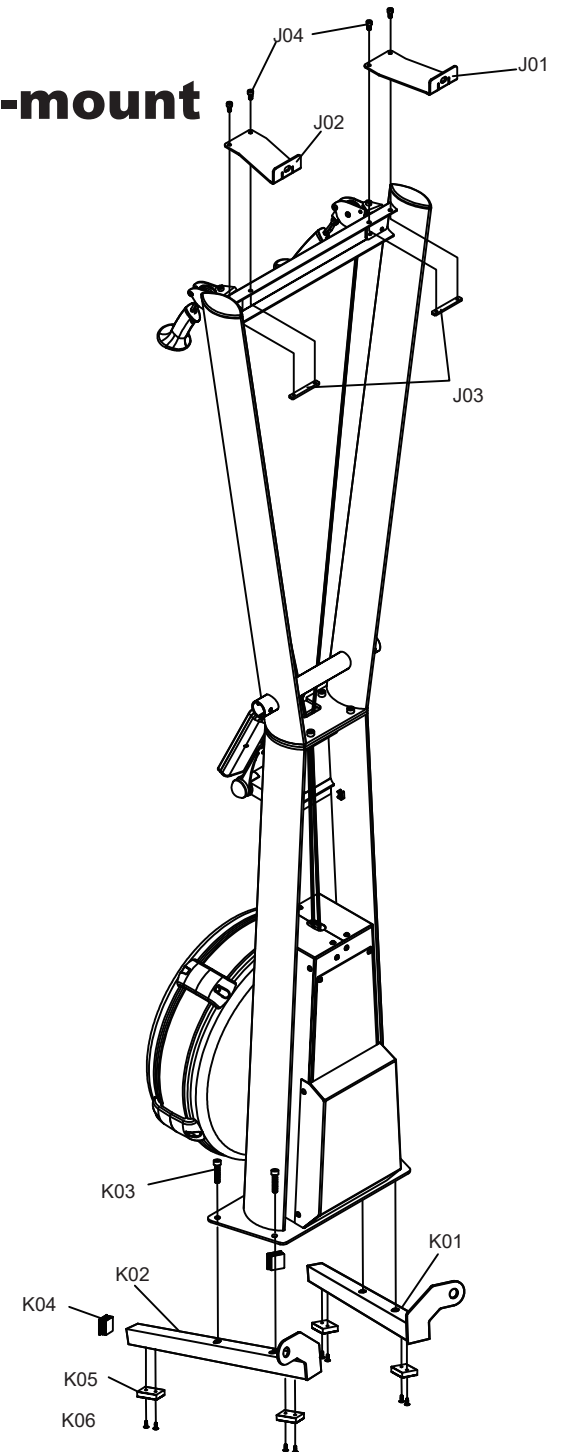

Spare parts list

Air Ski Trainer ECO ASKI-1-00-E

NO.	NAME	Q'TY	NO.	NAME	Q'TY
A01	Main Frame	1	A52	M3X8mm - Truss head Self-Tapping Screw	2
A02	L_Cover Plate	1	A53	M3X15mm - Pan Head Screw	2
A03	R_Cover Plate	1	A54	M3 - Hex nut	2
A04	Maintenance Hole Cover	1	A62	M5X10mm - Button Head Socket Screw	24
A05	Rear Housing	1	A63	M5X6mm - Button Head Socket Screw	2
A06	Front Cover	1	A67	φ7X15.8mm - Pulley Axle	2
A07	Rear Cover	1	A68	Bearing6201	1
A08	Drive Belt(250-J6)	1	A69	M6X1TX13mm - Flat Washer	4
A09	φ133 - Drive Belt Bracket	1	A70	M6X10mm - Truss head Screw	4
A10	φ50 - Drive Belt Bracket	1	B01	Support Frame	1
A11	Fan Axle	1	B02	Tube Cap	2
A12	S20 - Retaining Rings	2	B03	M8X16mm - Socket Screw	4
A13	M5X6mm - Truss head Screw	8	C01	Handle Bar	2
A14	Bearing6004	3	C02	M6X16mm - Socket Screw	8
A15	M10X25mm - Socket Screw	1	C03	Pulley Bracket	2
A16	Bearing6200	2	C04	Pulley Bracket Fixed Plate	2
A17	M10 - Plain Washer 1T	1	C05	Casing- Long	2
A18	M8 - Nylon Nut	1	C06	Casing- Short	2
A19	Idler Rack	1	C07	Pulley Bracket Bushing	4
A20	M4x10mm - Self-TappingScrew	12	C08	M6X65mm - Socket Screw	2
A21	M6X30mm - Socket Screw	1	C09	M6 - Nylon Nut	2
A22	M6 - Hex Nut	1	C10	M5X8mm - Button Head Socket Screw	8
A23	Spring and Rope Housing (Including Rope)	1	C11	φ42mm - Pulley With Two Spacers	4
A23-1	Rope (Without rope housing and spring)	X	C12	Carabiner	2
A24	M8X20mm - Socket Screw	1	C13	Rope Protective Case	2
A26	Wire Axle	1	C14	Knot Bracket A	2
A27	Anti Eccentric Axle	1	C15	M5 - Nylon Nut	2
A28	φ42mm - Pulley	2	C16	Knot Bracket B	2
A29	Spacer Ring-Short	1	C17	M5X16mm - Socket Screw	2
A30	S10 - Retaining Rings	2	C18	Pulley Bracket Protective Case	2
A31	STM-1 _ Bracket	4	D01	Console Holder	1
A34	Fan Center Tube	1	D02	Connecting Tube	1
A35	Wire End Cap	4	D03	Console Bushing	2
A36	Rear Chain Cover	1	D04	1/2" - Nut Cap	2
A37	Mesh	1	D05	1/2" x 3-1/4" - Socket Screw	1
A38	Right Chain Cover	1	D06	1/2" - Nylon Nut	1
A39	Adjust Disc	1	D07	1/2"x1Tx32 Flat Washer	2
A40	Fan	1	D08	M6X16mm - Socket Screw	3
A41	Fan Stable Bracket	1	D09	1/2"x2Tx23 Flat Washer	2
A44	Magnet Bracket	1	E01-E	Econ Console	1
A45	Round Magnet	1	E02	M5x10 - mmTruss head Screw	1
A46	M4X20mm-Truss head Self-Tapping Screw	4	E03	Induction Coil Connecting Wire	1
A47	M4XP0.75X10mm - Hex Cross Washer	8	E04	Console Connecting Wire	1
A48	M5X10mm - Socket Screw	4	E05	VR	1
A50	M4X12mm - Truss head Self-Tapping Screw	6	E06	VR Connecting Wire	1
A51	M6X20mm - Hex Socket Screw	2	E07	Induction Coil	1

NO.	NAME	Q'TY
Parts Of Floor Stand		
F01	Base Frame	1
F02	Caster	2
F03	Bushing	4
F04	M8X45mm - Truss Head Hex Socket Screw	2
F05	M8 - Hex Nut	2
F06	M8X35mm - Socket Screw	4
F07	30X30MM - Tube Cap	2
F08	Pad	1
G01	L_Upper Handrail Tube	1
G02	R_Upper Handrail Tube	1
G03	M6X45mm - Socket Screw	2
G04	M6 - Nylon Nut	2
H01	L_Lower Handrail Tube	1
H02	R_Lower Handrail Tube	1
H03	M6X16mm - Socket Screw	8
Parts Of Wall-mount		
J01	L_Top wall-mount Plate	1
J02	R_Top wall-mount Plate	1
J03	Fixed Plate	2
J04	M6X16mm - Socket Screw	4
K01	L_Bottom wall-mount Tube	1
K02	R_Bottom wall-mount Tube	1
K03	M8X35mm - Socket Screw	4
K04	30X30MM - Tube Cap	4
K05	Bottom Rubber Pad	4
K06	M4X12mm - Truss head Self-Tapping Screw	8