

XEBEX

FITNESS

CURVED TREADMILL ACTT-03 (ACTAR-08)

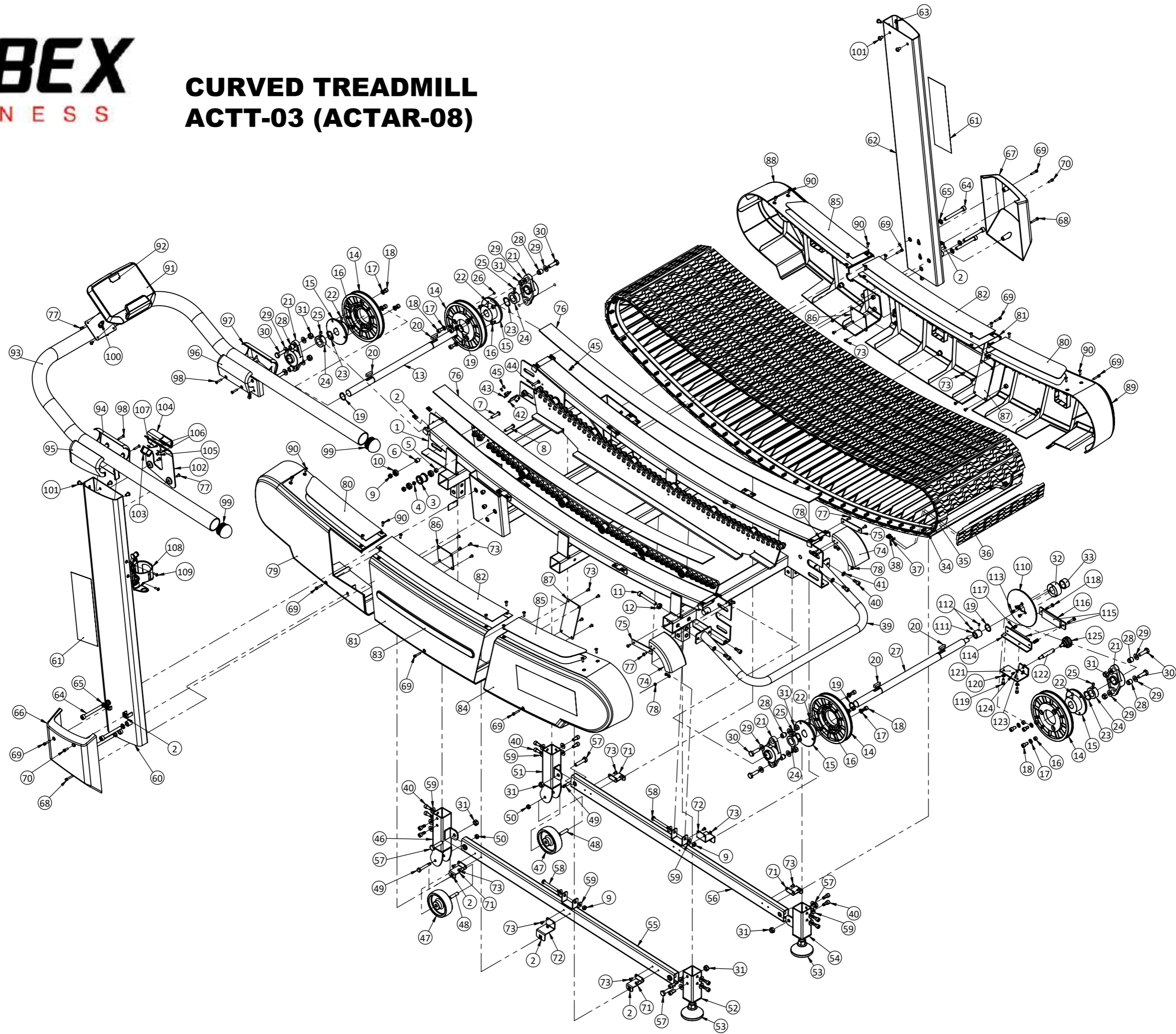

No.	Part Number	Description	Qty
1	501-3-1000-000	Main Frame	1
2	361-6-9005-00	No-Slip Clip-On Barrel Nuts -USN5×11×	20
3	501-6-1300-001	Roller	12
4	501-6-1301-001	Bearing Spacer 1-Ø12×Ø8.1×3.05	12
5	501-6-1302-001	Bearing Spacer 2-Ø12×Ø8.1×7	12
6	501-6-1303-001	Bearing Spacer 3-Ø12×Ø8.1×12	88
7	659-1-0080-05	Hex Screw- M8×1.25×35L	88
8	659-1-0080-30	Hex Bolt- M8×1.25×40L	12
9	661-2-0080-00	Hex Locknuts- M8×1.25	102
10	611-6-0608-070	Ball Bearing (NMB 608ZZ)	112
11	649-1-0100-365	Hex Bolts -M10×1.5×75L	4
12	651-2-0100-03	Hex Nut-M10×1.5	4
13	501-6-1500-001	Front Pulley axis	1
14	501-6-1501-001	Pulley	4
15	501-6-1502-001	Pulley Plate	4
16	501-6-1503-001	Pulley Spacer-Ø12×Ø8.1×6.8	12
17	603-3-0083-00	Washer (Black)- Ø16×Ø8.3×1.6t	12
18	649-1-0080-07	Hex Bolts-M8×1.25×16L	12
19	667-5-0250-00	C type Buckle (shaft) black NO.25	4
20	501-6-1504-000	Square Key 8×8×30L	4
21	635-6-0205-000	Pillow Block Bearing(UCFL205)	4
22	644-1-0060-061	Hex Bolt -M6×1.0×10L	4
23	611-3-0267-00	Wave Washer (black)-Ø33.9×Ø26.2×0.4t	4
24	334-6-6001-00	Fixed Ring	4
25	644-1-0080-03	Hex Bolts-M8×1.25×8L	4
26	348-6-5309-001	NdFeB Magnet (D6×6L)	1
27	501-6-1705-001	Rear Pulley axis	1
28	501-6-1505-000	Pillow Block Bearing spacer 1 Ø15.9×Ø8.1×16.6	6
29	603-3-0105-03	Washer (Nickel)- Ø22×Ø10.5×2t	16
30	653-1-0100-08	Hex Bolts-M10×1.5×35L	8
31	661-2-0100-00	Hex Locknuts-M10×1.5	12
32	501-6-1707-101	One Way Bearing Bracket- ANODIZED	1
33	624-6-2520-000	One Way Bearing -INA HF2520	1
34	501-6-1200-000	Belt	2
35	501-6-1201-001	Bumper Rubber Strap	4

36	501-3-1202-001	Running Belt	60
37	501-6-1204-000	Oval Ring Washer-19×9×1t	120
38	649-1-0050-231	Hex Bolt-M5×0.8×12L	240
39	501-3-2200-00042	Transport Handle Assembly	1
40	649-1-0080-06	Hex Bolt-M8×1.25×20L	20
41	603-3-0083-00	Flat Washer-Ø16×Ø8.3×1.6t	4
42	504-6-2004-001	Sensor Switch Mounts	1
43	376-6-5474-000	Reed Switch Holder	1
44	501-6-2003-001	Reed Switch Assembly	1
45	659-1-0040-06	Hex Bolt-M4×0.7×8L	4
46	501-3-2400-00042	Left Transport Wheel Assembly	1
47	501-6-2403-000	Transport Wheel	2
48	501-6-2404-001	Transport Wheel Bushing	2
49	653-1-0080-19	Hex Bolt-M8×1.25×55L	2
50	661-2-0080-00	Hex Locknut-M8×1.25	2
51	501-3-2600-00042	Right Transport Wheel Assembly	1
52	501-3-3000-00042	Left Rear Vertical Assembly	1
53	501-6-3002-000	Leveling Foot	2
54	501-3-3200-00042	Right Rear Vertical Assembly	1
55	501-3-2800-00042	Left Horizontal Assembly	1
56	501-3-2900-00042	Right Horizontal Assembly	1
57	653-1-0100-203	Hex Bolt-M10×1.5×45L	4
58	653-1-0080-315	Hex Bolt-M8×1.25×70L	2
59	603-3-0083-02	Flat Washer-Ø20×Ø8.3×2t	20
60	501-3-3400-000	Upright Assembly-Left	1
61	501-6-3404-000	Decal- Upright for XEBEX	2
62	501-3-3600-00042	Upright Assembly-Right	1
63	501-6-2002-001	Reed Switch Connecting Cable 2	1
64	649-1-0100-09	Hex Bolt-M10×1.5×90L	6
65	603-3-0105-08	Washer-Ø18×Ø10.5×1.5t	6
66	501-6-7005-001	Sidecase Center Cover-Left	1
67	501-6-7006-001	Sidecase Center Cover-Right	1
68	649-1-0050-17	Hex Bolt-M5×0.8×30L	2
69	649-1-0050-18	Hex Bolt-M5×0.8×25L	8
70	649-1-0050-626	Hex Bolt-M5×0.8×16L	2
71	501-6-7012-001	Sidecover connecting Bracket 3	4
72	501-6-7013-001	Sidecover connecting Bracket 4	2

73	659-1-0050-14	Hex Bolt-M5×0.8×10L	28
74	501-6-1100-001	Rear Cover Supporting plate	2
75	501-6-1101-001	Rear Cover Locking plate	2
76	501-6-1102-001	EVA Bumper Strap	2
77	659-1-0050-23	Hex bolt-M5×0.8×12L	14
78	661-2-0050-01	Hexa locknut-M5×0.8	8
79	501-6-7000-001	Sidecase-Left Front	1
80	501-6-7008-001	Antislip Pad 1	2
81	501-6-7004-001	Sidecase-Middle	2
82	501-6-7009-001	Antislip Pad 2	2
83	501-6-7007-001	Decal-Sidecover Middle	2
84	501-6-7002-100	Sidecase-Left Rear	1
85	501-6-7014-001	Antislip Pad 3	2
86	501-6-7010-001	Cover connecting plate 1	2
87	501-6-7011-001	Cover connecting plate 2	2
88	501-6-7001-001	Sidecase-Right Front	1
89	501-6-7003-100	Sidecase-Right Rear	1
90	658-1-0050-195	Head hex screw-M5×0.8×16L	24
91	501-3-2010-000	Console Assembly	1
92	501-6-2006-001	Decal-Console for XEBEX	1
93	501-3-3800-00099	Handlebar Assembly	1
94	501-6-3804-001	Upright cover-Left Inner	1
95	501-6-3805-001	Upright cover-Left Outer	1
96	501-6-3806-001	Upright cover-Right Inner	1
97	501-6-3807-001	Upright cover-Right Outer	1
98	658-1-0050-186	Flat Head Cross Bolt-M5×30mm	4
99	501-6-3808-001	Round Pipe Cap	2
100	501-6-2001-001	Reed Switch Connecting Cable 1	1
101	659-1-0080-046	Hex Bolt-M8×1.25×12L	6
102	501-6-4000-00042	Cellphone Holder (coating)	1
103	501-3-4001-001	Adjustment Knob	1
104	501-3-4002-001	Cellphone Holder	2
105	659-1-0050-19	Hex bolt-M5×0.8×6L	1
106	603-3-0055-02	Flat Washers-Ø15×Ø5.5×1.5t	2
107	603-3-0053-030	Plastic Washer-Ø20×Ø5.3×1.5t	1
108	367-6-7307-00	Water Bottle Holder	1
109	659-1-0050-20	Hex bolt-M5×0.8×16	2

110	501-6-1708-001	Brake Pad	1
111	501-6-1706-000	Bearing Bushing-Ø25×Ø15×23	1
112	644-1-0050-00	Hexagon Socket Head Head Cap Bolt-M5×0.8	2
113	658-1-0050-154	Head hex socket bolt-M5×0.8×10L	3
114	501-6-1103-001	Friction plate L-shaped plate	1
115	501-6-1104-000	Friction plate	2
116	501-6-1105-001	Friction plate pressure plate	1
117	501-6-1106-001	Brake pressure spring	2
118	653-1-0060-241	Hex head bolt-Nickel Plated/Nylok	2
119	649-1-0060-18	Head hex socket bolt-M6×1.0×16L	2
120	603-3-0064-012	Flat Washer-Ø12.5×Ø6.4×1.6t	2
121	501-3-1800-001	Connection Plate Assy-zinc	1
122	501-6-1801-001	Brake Spindle	1
123	603-3-0042-01	Washer-Ø10×Ø4.2×0.8	1
124	649-1-0040-104	Hexagon Socket Head Head Cap Bolt-M4×0.7	1
125	501-6-1802-001	Knob screw	1