

CURVED AIRPLUS TREADMILL ACRT-02

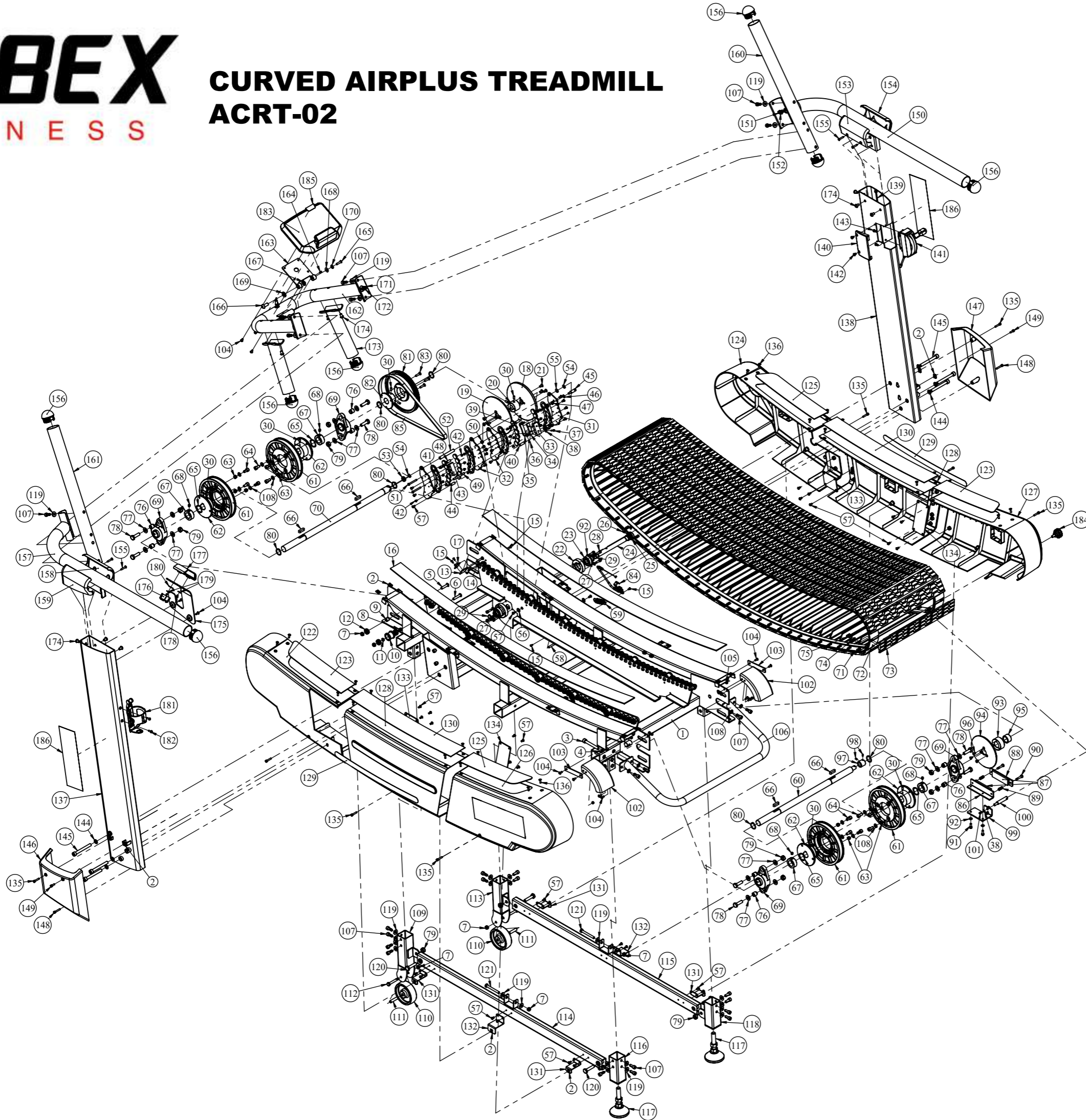

No.	Part Number	Description	Qty
1	501-3-1050-00042	Main Frame	1
2	361-6-9005-00	No-Slip Clip-On Barrel Nuts -USN5×11×17mm	30
3	649-1-0100-365	Hex Bolts -M10×1.5×75L	4
4	651-2-0100-03	Hex Nut-M10×1.5	4
5	659-1-0080-05	Hex Screw- M8×1.25×35L	88
6	659-1-0080-30	Hex Bolt- M8×1.25×40L	12
7	661-2-0080-00	Hex Locknuts- M8×1.25	104
8	501-6-1302-001	Bearing Spacer 2-Ø12×Ø8.1×7	12
9	501-6-1303-001	Bearing Spacer 3-Ø12×Ø8.1×12	88
10	501-6-1300-001	Roller	12
11	501-6-1301-001	Bearing Spacer 1-Ø12×Ø8.1×3.05	12
12	611-6-0608-070	Ball Bearing (NMB 608ZZ)	112
13	501-6-2004-001	Induction fixed mount	1
14	501-6-2003-001	Reed Switch Assembly	1
15	659-1-0040-06	Hex Bolt-M4×0.7×8L	6
16	501-6-1102-001	EVA Bumper Strap	2
17	376-6-5474-000	Reed Switch Holder	1
18	501-6-1600-001	Induction aluminum plate-wide(Anode)	1
19	501-6-1606-001	Induction aluminum plate-narrow(Anode)	1
20	501-6-1601-001	Aluminum plate fixing mount	1
21	658-1-0060-03	Hexagon socket head bolts-M6×1.0×12L	6
22	501-6-1602-001	Drive wheel bearing	2
23	611-6-6203-010	6203ZZ Ball bearing	2
24	501-6-1603-001	Drive axle	1
25	501-6-1604-001	Drive small pulley	1
26	644-1-0060-077	Hex socket head fixing bolt-M6×1.0×10L	2
27	603-3-0171-002	Flat washer-Ø23×Ø17.1×2t	2
28	649-1-0060-285	Hex socket bolt-M6×1.0×20L	6
29	667-5-0170-00	C-type buckle	2
30	644-1-0060-061	Hex socket head fixing bolt-M6×1.0×12L	8
31	501-6-1400-001	Right magnet fixing plate (processing)	1
32	501-6-1401-001	Left magnet fixing plate	3
33	501-6-1402-001	Brake connector	1
34	501-6-1403-001	Brake support	1
35	501-6-1404-000	Brake pads	1
36	658-1-0040-124	Hexagon socket head bolts-M4×0.7×8L	2

No.	Part Number	Description	Qty
37	649-1-0040-06	Hex socket head bolts-M4×0.7×16L	2
38	603-3-0042-01	Washer-Ø10×Ø4.2×0.8	3
39	505-6-2802-001	Magnet	12
40	501-6-1406-001	Magnetic control fixed axis 1	2
41	501-6-1407-001	Magnet positioning plate	4
42	659-1-0040-126	Hexagon socket head bolts-M4×0.7×6L	24
43	501-6-1408-001	Magnetic control connecting plate	1
44	501-6-1413-001	Magnetic control fixed axis 2	1
45	501-6-1409-001	Cable shaft	1
46	603-3-0062-001	Plastic washer	2
47	661-2-0060-00	Hex lock nuts-M6×1.0	1
48	501-6-1410-001	Magnet connection shaft	1
49	501-6-1411-001	Spring rod	1
50	501-6-1412-001	Magnetically controlled spacer ring	2
51	659-1-0050-356	Hexagon socket head bolts-M5×0.8×45L	2
52	501-6-1414-001	Magnetic control shaft	1
53	501-6-1415-001	Magnetic control shaft spacer ring	1
54	611-3-0100-02	Wave washer-WW-10 (0.5T)	2
55	313-6-1211-00	Roller shim gasket	1
56	603-3-0055-00	Flat washer	2
57	659-1-0050-14	Hexagon socket head bolts-M5×0.8×10L	43
58	501-6-1416-001	Spring rod-frame	1
59	501-6-1417-001	Tension spring	1
60	501-6-1705-001	Rear pulley axis	1
61	501-6-1501-001	Pulley	4
62	501-6-1502-001	Pulley Plate	4
63	501-6-1503-001	Pulley Spacer-Ø12×Ø8.1×6.8	12
64	649-1-0080-07	Hex Bolts-M8×1.25×16L	12
65	611-3-0267-00	Wave Washer (black)-Ø33.9×Ø26.2×0.4t	4
66	501-6-1504-000	Square Key 8×8×30L	4
67	334-6-6001-00	Fixed Ring	4
68	644-1-0080-03	Hex Bolts-M8×1.25×8L	4
69	635-6-0205-000	Pillow Block Bearing(UCFL205)	4
70	501-6-1506-001	Front pulley shaft	1
71	501-6-1200-000	Belt	2
72	501-6-1201-001	Bumper Rubber Strap	4

No.	Part Number	Description	Qty
73	501-3-1202-020	Slat	60
74	501-6-1204-000	Oval Ring Washer-19×9×1t	120
75	659-1-0050-365	Hexagon socket head bolts-M5×0.8×12L	240
76	501-6-1505-000	Pillow Block Bearing spacer 1	8
77	603-3-0105-03	Washer (Nickel)- Ø22×Ø10.5×2t	16
78	653-1-0100-08	Hex Bolts-M10×1.5×35L	8
79	661-2-0100-00	Hex Locknuts-M10×1.5	12
80	667-5-0250-00	C type Buckle (shaft) black NO.25	6
81	501-6-1507-001	Drive large pulley	1
82	501-6-1508-001	Drive wheel fixing mount	1
83	658-1-0060-195	Hexagon socket head bolts-M6×1.0×25L	3
84	501-6-1607-001	Double hook cable	1
85	501-6-1608-001	Elastic belt	1
86	501-6-1103-001	Friction plate L-shaped plate	1
87	501-6-1104-000	Friction plate	2
88	501-6-1105-001	Friction plate pressure plate	1
89	501-6-1106-001	Brake compression spring	2
90	653-1-0060-241	Hexagon head bolt-M6×1.0×30L	2
91	649-1-0060-18	Hex socket bolt-M6×1.0×16L	2
92	603-3-0064-012	Flat washer-Ø12.5×Ø6.4×1.6t	8
93	501-6-1707-101	One-way bearing mount(anode)	1
94	501-6-1708-001	Brake pads	1
95	624-6-2520-000	One- way bearing-INA HF2520	1
96	658-1-0050-154	Hexagon socket head bolts-M5×0.8×10L	3
97	501-6-1706-000	Bearing bushing	1
98	644-1-0050-00	Hex socket fixing bolt-M5×0.8×8L	2
99	501-3-1800-001	Connection plate assy	1
100	501-6-1801-001	Brake screw	1
101	649-1-0040-104	Hex socket head bolts-M4×0.7×6L	1
102	501-6-1100-001	Rear Cover Supporting plate	2
103	501-6-1101-001	Rear Cover Locking plate	2
104	659-1-0050-23	Hex bolt-M5×0.8×12L	14
105	661-2-0050-01	Hexa locknut-M5×0.8	8
106	501-3-2200-00042	Transport Handle Assembly	1
107	649-1-0080-06	Hex Bolt-M8×1.25×20L	28
108	603-3-0083-00	Flat Washer-Ø16×Ø8.3×1.6t	16

No.	Part Number	Description	Qty
109	501-3-2400-00042	Left Transport Wheel Assembly	1
110	501-6-2403-000	Transport Wheel	2
111	501-6-2404-001	Transport Wheel Bushing	2
112	653-1-0080-19	Hex Bolt-M8×1.25×55L	2
113	501-3-2600-00042	Right Transport Wheel Assembly	1
114	501-3-2800-00042	Left Horizontal Assembly	1
115	501-3-2900-00042	Right Horizontal Assembly	1
116	501-3-3000-00042	Left Rear Vertical Assembly	1
117	501-6-3002-000	Leveling Foot	2
118	501-3-3200-00042	Right Rear Vertical Assembly	1
119	603-3-0083-02	Flat Washer-Ø20×Ø8.3×2t	28
120	653-1-0100-203	Hex Bolt-M10×1.5×45L	4
121	653-1-0080-315	Hex Bolt-M8×1.25×70L	2
122	501-6-7000-001	Sidecase-Left Front	1
123	501-6-7008-001	Antislip Pad 1	2
124	501-6-7001-001	Sidecase-Right Front	1
125	501-6-7014-001	Antislip Pad 3	2
126	501-6-7002-100	Sidecase-Left Rear	1
127	501-6-7003-100	Sidecase-Right Rear	1
128	501-6-7004-001	Sidecase-Middle	2
129	501-6-7007-001	Decal-Sidecover Middle	2
130	501-6-7009-001	Antislip Pad 2	2
131	501-6-7012-001	Sidecover connecting Bracket 3	4
132	501-6-7013-001	Sidecover connecting Bracket 4	2
133	501-6-7010-001	Cover connecting plate 1	2
134	501-6-7011-001	Cover connecting plate 2	2
135	649-1-0050-18	Hex Bolt-M5×0.8×25L	8
136	658-1-0050-195	Head hex screw-M5×0.8×16L	24
137	501-3-3400-00042	Upright Assembly-Left	1
138	501-3-3610-00042	Upright Assembly-Right	1
139	501-6-2002-001	Reed Switch Connecting Cable 2	1
140	501-6-3604-001	Square cover	1
141	501-6-3605-001	Airplus lever	1
142	658-1-0050-04	Hexagon socket head bolts-M5×0.8×10L	2
143	653-1-0050-052	Hexagon head bolt-M5×0.8×10L	2
144	603-3-0105-08	Washer-Ø18×Ø10.5×1.5t	6

No.	Part Number	Description	Qty
145	649-1-0100-09	Hex Bolt-M10×1.5×90L	6
146	501-6-7005-001	Sidecase Center Cover-Left	1
147	501-6-7006-001	Sidecase Center Cover-Right	1
148	649-1-0050-17	Hex Bolt-M5×0.8×30L	2
149	649-1-0050-626	Hex Bolt-M5×0.8×16L	2
150	501-3-3700-00099	Handlebar Assembly-Right	1
151	501-6-2012-001	Resistance detection cable 2	1
152	501-6-2013-001	Reed Switch Connecting Cable 3	1
153	501-6-3806-001	Upright cover-Right Inner	1
154	501-6-3807-001	Upright cover-Right Outer	1
155	658-1-0050-186	Cross head bolt-M5×30	4
156	501-6-3808-001	Round Pipe Cap	8
157	501-3-3900-00099	Handlebar Assembly-Left	1
158	501-6-3804-001	Upright cover-Left Inner	1
159	501-6-3805-001	Upright cover-Left Outer	1
160	501-3-4100-00099	Right thrust handlebar assy	1
161	501-3-4200-00099	Left thrust handlebar assy	1
162	501-3-4300-00099	U-shaped handle assy	1
163	501-3-3815-001	Console positioning assy	1
164	644-1-0040-047	Hex socket fixing bolt-M4×0.7×10L	1
165	659-1-0060-396	Hexagon socket head bolts-M6×1.0×25L	1
166	659-1-0100-136	Hexagon socket head bolts-M10×1.5×25L	1
167	611-3-0102-00	Disc spring	1
168	606-3-0062-00	Disc spring	1
169	603-3-0102-050	Plastic washer	1
170	603-3-0064-061	Flat washer	1
171	501-6-2011-001	Resistance detection adapter cable 1	1
172	501-6-2014-001	Reed switch extension cable 4	1
173	501-3-4310-00099	Handrail assy	2
174	659-1-0080-046	Hex socket socket head bolt-M8×1.25×12L	10
175	501-6-4000-00042	Cellphone Holder (coating)	1
176	501-3-4001-001	Adjustment Knob	1
177	501-3-4002-001	Cellphone Holder	2
178	659-1-0050-19	Hex bolt-M5×0.8×6L	1
179	603-3-0055-02	Flat Washers-Ø15×Ø5.5×1.5t	2
180	603-3-0053-030	Plastic Washer-Ø20×Ø5.3×1.5t	1

No.	Part Number	Description	Qty
181	367-6-7307-00	Water Bottle Holder	1
182	659-1-0050-20	Hex bolt-M5×0.8×16	2
183	501-3-2010-000	Console	1
184	501-6-1802-001	Knob screw	1
185	501-6-2006-001	Console logo label-XEBEX	1
186	501-6-3404-000	Upright handle label-XEBEX	2